

907

MAIN

CENTRAL SQ

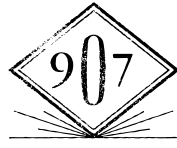



617-354-9907 | INFO@907MAIN.COM | 907 MAIN STREET, CAMBRIDGE, MA 02139 | 907MAIN.COM



THIS IS 907 MAIN

ABOUT:

Located in the heart of Central Square in Cambridge MA, 907 Main celebrates and embraces the diversity of the neighborhood.

Inspired by Margaret Fuller and the transcendentalist movement, the hotel features exclusive offerings and partnerships that provide a sophisticated and refined stay while inspiring guests and locals to embrace the rebel within.

GUEST ROOMS:

67 Beautifully appointed guestrooms

PENTHOUSE SUITE:

1000 square feet

Two king bedded rooms, 2 full bathrooms, a conference table that seats 6-8, a private balcony, and AV compatible

AMENITIES:

– The Dial Restaurant and patio that serves breakfast lunch and dinner and Blue Owl Bar and terrace

Plush Pillow top bedding

Luxury Guild + Pepper bathroom amenities

Grab n Go dining option

Iris hotel mobile app

Access hotel information & amenities, order in-room dining, check weather, news and flights

– Complimentary wi-fi

– In-room dining

– Parking available

– Express check in request via mobile app

– 55" LCD/HD Smart TV

Connect your own device to stream movies via Netflix and Hulu, and access your social media apps

– Bluetooth and wireless charging alarm clock

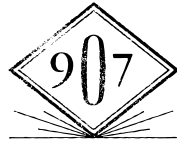

EAT & DRINK

The DIAL

KITCHEN · BAR · PATIO

An urban eatery and bar with a mid-century modern vibe, The Dial offers eclectic food and drink in a space designed to awaken inner rock stars.

From happy hours to date nights, kick back and enjoy communal, patio and private dining in a modern, urban atmosphere. Iconic cocktails and dishes from around the world are served while stylistic touches pay homage to Cambridge's legendary music clubs.

Complete with an outdoor street-level expanse that spills out into the neighborhood, The Dial restaurant and bar captures the vibrant essence of the city.



Boasting the only rooftop terrace and bar in Cambridge; is a place to let loose and unwind.

Enjoy any one of our signature craft cocktails, share a bottle of wine or snack on street food small plates from around the world at eye-level with the city skyline.

As a quick-hitting extension of our restaurant, The Dial, join us upstairs to kick off an evening of possibilities, or wind down an epic night.



PLANNING A PRIVATE EVENT?

Our untraditional meeting space offers eclectic menus with seasonal dining options. The Dial offers versatile communal, patio and private dining choices for a perfect meeting and meal.

Boasting the only rooftop bar in Cambridge, MA, the Blue owl is sure to bring dining to the next level. The property features a penthouse with a conference table for eight, private balcony and two private king bedrooms. Central Square is in the heart of Cambridge, edged by Kendall and Harvard Square.

BLUE OWL & PENTHOUSE

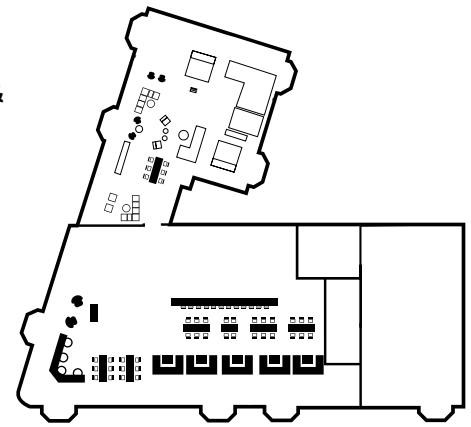

THE DIAL

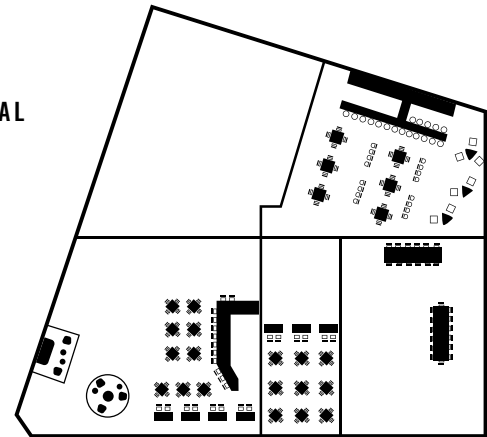

UNIQUE PRIVATE EVENT SPACE	MAC OCC.	SEATED	SQ. FT.
The Dial Buyout (includes PDR and Main DR)	250	105	1250
The Dial Private Dining Room	50	50	500
The Dial Main Dining Room	200	55	750
The Dial Patio	320	100	1601
Penthouse	25	12	1000
Blue Owl Buyout (includes terrace and bar)	175	75	1820
Blue Owl Terrace	100	25	1011
Blue Owl Bar	75	50	809